

Ringer Switch LO / HI

Your phone provides a ringer adjustment of High and Low.

FLASH KEY

This key is for getting a new line if you make a mistake when dialing or it is also used to answer a call waiting call...

MEMORY FEATURE

To Program

Your PHONE is equipped with 911 memory key plus 2 one touch memory keys (M1, M2).

STORE IN : DIALING NUM. DESIRED + STORE + M1(M2)
OR 911 BUTTON

DIAL OUT : Pick up handset + M1 (M2)

NOTICE : If your home has specially wired alarm equipment connected to the telephone line, ensure the installation of this equipment CP08481 does not disable your alarm equipment. If you have questions about what will disable alarm equipment, consult your telephone company or a qualified installer.

WARNING : Changes or modifications to this unit not expressly approved by the party responsible for compliance could void the user's authority to operate the equipment.

USER MANUAL

Home
Intuition



• Please follow instructions for repairing if any otherwise do not alter or repair any parts of device except specified.

IMPORTANT SAFETY INSTRUCTIONS

Before using your telephone equipment, basic safety precautions should always be followed to reduce the risk of fire, electric shock and injury to persons including the following:

- 1. Read and understand all instructions.
- 2. Follow all warnings and instructions marked on the product.
- 3. Unplug this product from the wall outlet before cleaning. Do not use liquid or aerosol cleaners. Use a damp cloth for cleaning.
- 4. Do not use this product near water, for example, near a bath tub, wash bowl, kitchen sink, or laundry tub, in a wet basement or near a swimming pool.
- 5. Do not place this product on an unstable cart, stand, or table. The product may fall causing serious damage to the product.

SAVE THESE INSTRUCTIONS

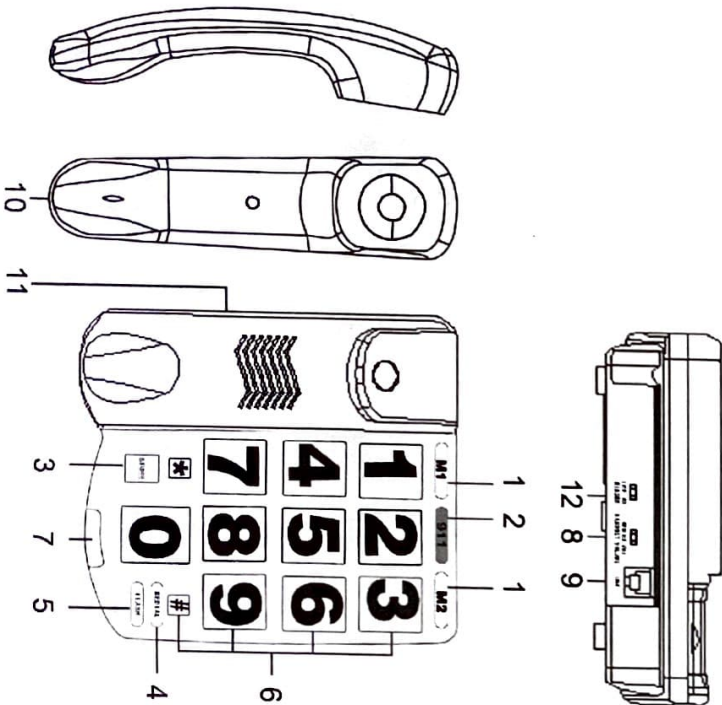

1	Direct Memory Keys	8	Handset volume Med-HI-VHI Switch
2	911 memory Key	9	Line Jack Socket
3	Store Key	10	Handset Socket
4	Redial Key	11	Handset Socket
5	Flash Key	12	RINGER LO/HI Switch
6	Dialing Key		
7	Ringer Light		

INSTALLATION

Coil Cord Connection

Insert coil cord into modular jack located on left hand side housing. Connect the other end into the modular jack located on handset.

Line Cord Connection

Insert the modular plug of the straight cord into the rear side of base unit, the insert the other end of RJ11C plug into the wall jack.

OPERATION

KEY FEATURE

Last Number Redial

Your PHONE remembers the last number dialed. If the number you dial is busy or not being answered, hang up. To redial the last number automatically, press the REDIAL button. NOTE: You can redial the same telephone number as many times as required. However, once you dial another number, the previous number is erased.